



## DAS NEUE SCHLOSS MEERSBURG (MEERSBURG NEW PALACE)

### *Princely pleasure*

The magnificent Neues Schloss Meersburg on beautiful Lake Constance is considered one of the finest Baroque residences in the region – and an absolute dream come true for high-profile events. Not only do you have access to the café run by Traube Tonbach and its lovely view of the lake, but also to the elegant halls and salons.



### CAFÉ AT NEUES SCHLOSS MEERSBURG

The Café at Neues Schloss Meersburg invites connoisseurs and palace visitors to enjoy moments of pure relaxation whenever the museum is open. Its preferred location on Lake Constance and spacious sun terrace make it a spectacular venue for unforgettable events. The historic room is decorated in classic modern style and offers seating for approximately 34 people. Complete with a captivating panoramic view of Lake Constance, the Palace Terrace can accommodate up to 100 people, almost as if it had been predestined to host fashionable summer parties and stylish receptions. Traube Tonbach's impressive culinary range promises an abundance of delicious choices for every occasion, from exquisite finger food or regionally inspired buffets to extravagant five-course meals.

### WEDDINGS

Celebrations with up to 160 people and a dance floor in the Garden Hall are a cinch to pull off. As Neues Schloss Meersburg is a very popular wedding location, early bookings are recommended.

### MEETINGS

Neues Schloss Meersburg offers seven meeting rooms, ranging from small rooms with 41 m<sup>2</sup> to the large Hall of Mirrors with 140 m<sup>2</sup>. Furthermore, the Garden Hall – located on the ground floor facing the terrace – is available for use as of 6:00 pm.

### DISTANCES

Constance* 10 km	Friedrichshafen 19 km	Lindau 42 km	Traube Tonbach 150 km
Stuttgart 186 km	Winterthur 52 km	Zurich 80 km	Bregenz 57 km

*\*(with ferry connection)*

## MEETING PACKAGE

- Welcome coffee with butter pretzels, fruit salad, and yogurt
- A morning and afternoon coffee break
- Lunch in the form of a three-course meal
- A selection of soft drinks, coffee, and tea with lunch

42,00 PER PERSON (including VAT)

*The meeting package does not include room rental fees or audio-visual equipment. These must be requested through [Staatliche Schlösser und Gärten Baden-Württemberg](#). Please refer to the [YOUR CONTACTS](#) section for more information.*

# PLANNING INFORMATION AND DETAILS

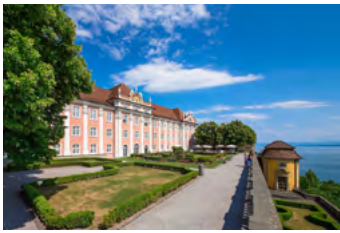

## ROOM CAPACITIES FIRST FLOOR

Room Name	m <sup>2</sup>	Theater	U-Shape	Parliament	Banquet w/ Round Tables	Banquet w/ Oval Tables	Rental Fee
Café (approx. 34 seats)	53	-	-	-	-	-	-
Terrace	170	-	-	-	-	-	-
Garden Hall	189	-	-	-	-	-	464.10**
1 Bagnato*	119	-	53	-	80	80	648.55**
2 Appiani*	106	-	32	-	60	80	565.25**

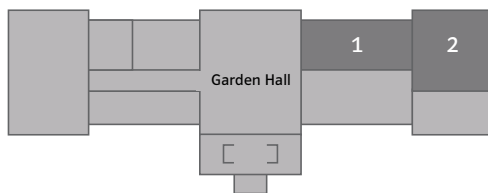

\* Not suitable for theater or parliamentary seating due to columns

## ROOM CAPACITIES SECOND FLOOR

Room Name	m <sup>2</sup>	Theater	U-Shape	Parliament	Banquet w/ Round Tables	Banquet w/ Oval Tables	Rental Fee
3 Stauffenberg	49	40	20	18	30	40	273.70**
4 Schönborn	90	72	32	45	70	70	From 238.00**
5 Rodt	70	49	29	24	50	60	440.30**
6 Dalberg	41	28	17	12	30	30	255.85**

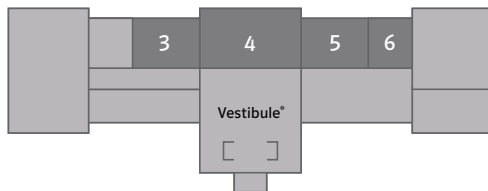

\* For concerts in the stairwell, seating will be arranged in the vestibule (second floor, 98 m<sup>2</sup>) and the Hall of Mirrors' anteroom (third floor, 75 m<sup>2</sup>) for 104 and 28 people, respectively. The stairwell can thus accommodate 132 people with concert seating.

## ROOM CAPACITIES THIRD FLOOR

Room Name	m <sup>2</sup>	Theater	U-Shape	Parliament	Banquet w/ Round Tables	Banquet w/ Oval Tables	Rental Fee
7 Hall of Mirrors	140	159	38/52*	60	-	-	From 969.85**

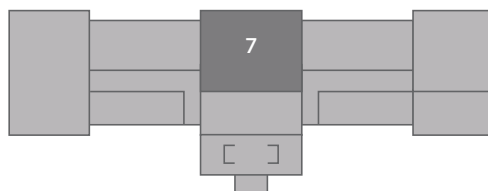

\* 38 (open U), 52 (closed U)

\*\*All prices are in euro including VAT per day during the respective official opening hours, plus all additional costs unless otherwise stated. A lump sum of 238.00 is charged for event support outside normal business hours. The Hall of Mirrors is only rented upon request. Subject to change.

## YOUR CONTACTS

Catering inquiries and bookings:

Jessica Scheffold, Operations Manager

Phone +49 (0) 75 32/80 79 41 20 | Cell +49 (0) 151/1933 90 95

Email: [jessicascheffold@neuesschlossmeersburg.de](mailto:jessicascheffold@neuesschlossmeersburg.de)

Rental inquiries and bookings:

Susanne Bogoslaw, Neues Schloss Meersburg

Phone +49 (0) 75 32/80 79 41 16

Email: [Susanne.Bogoslaw@ssg.bwl.de](mailto:Susanne.Bogoslaw@ssg.bwl.de)